

Super Pro Dual Extension Ladder

2 x 7 Steps | 3,5 m



✓ EN131

SUPER PRO

3 YEAR WARRANTY

Specifications

- Length: 3.5 m
- Transport Length: 2.1 m
- Transport Width: 0.515 m
- Steps: 2 x 7
- Weight: 10 kg
- Width: 51.5 cm
- Colour: Grey
- Load Capacity: 150 kg
- Certification: EN131
- Jumbo Brand: SUPER PRO LADDERS

Product no.	DBNumber	EAN Code	Jumbo Brand	Warranty	Net Weight
41JSS207	1845798	5708375221734	SUPER PRO LADDERS	3 years	10 kg

Description

JUMBO Super Pro Dual Extension Ladder is an extra powerful ladder in craftsman quality. The ladder is made of 6005-T6 aluminium - sturdy & durable ladder, while keeping weight. The ladder has 38 mm ergonomic, angled & non-skid steps, for a plane and safe standing ground. Sidepieces and steps in anodized aluminum - no dirty fingers! Durable top wheel & nylon fittings in aluminium mounts secure fast & easy extension For extra safety, a Self-locking mechanism crafted from aluminium.

Base Stabilizer with solid feet in non-slip, durable material can be purchased - for extra safety and stability.

NOTE: To meet the requirements of the configuration of leaning ladders according to EN131-Proffesional, dual extension ladders including a base stabilizer should be chosen from a ladder length of 3 meters

Detail Images



Anodized aluminium steps and sidepieces - no dirty fingers!



38mm ergonomic, angled & non-skid steps, for a plane and safe standing ground



Durable top wheel & nylon fittings in aluminium mounts secure fast & easy extension

The set consists of

STK | |

Spareparts



Rubber foot
41JSS900



Bottom bracket
41JSS905



Pop rivet
41JSS904



Step lock set
41JSS906



Top clips set
41JSS907



Wall Wheel
41JSS909



Bolt set
41JSS909B



Top plug
41JSS912



Inner lining
41JSS922

Accessories

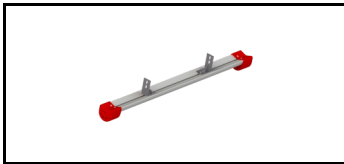

Super Pro Base Stabilizer
41JSF100
1838490